

## DOWNTOWN LIMITED DISTRICT (PROPOSED DIMENSIONAL REQUIREMENTS)

### Dimensions and Siting:

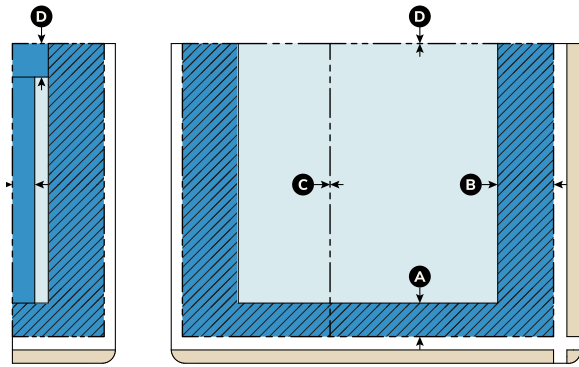

### Dimensions and Siting

	Minimum Lot Area	None
	Minimum Lot Width	None
<b>A</b>	Front Setback <sup>1</sup>	0-15 ft Build-to Zone
<b>B</b>	Corner Side Setback <sup>1</sup>	0-25 ft Build-to Zone
<b>C</b>	Minimum Interior Side Setback	0 ft, unless abutting residential district or DT-T District, then 10 ft
<b>D</b>	Minimum Rear Setback	0 ft, unless abutting residential district or DT-T District, then 15 ft

- <sup>1</sup> When the front or corner side lot line intersects or overlaps with the right-of way line, the required build-to zone is measured from a line representing the average location of front lot lines along the same block. In no case shall a building be placed forward of this line.

### Buildout:

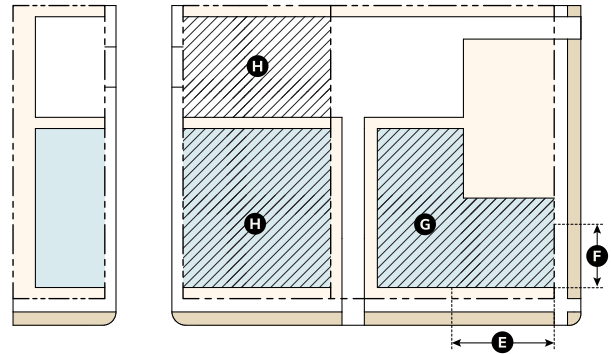

### Buildout

<b>E</b>	Minimum Front Build-to Percentage	60%
<b>F</b>	Minimum Corner Side Build-to Percentage	40%
<b>G</b>	Maximum Building Coverage	65%
<b>H</b>	Maximum Impervious Surface Coverage	80%

## Height:

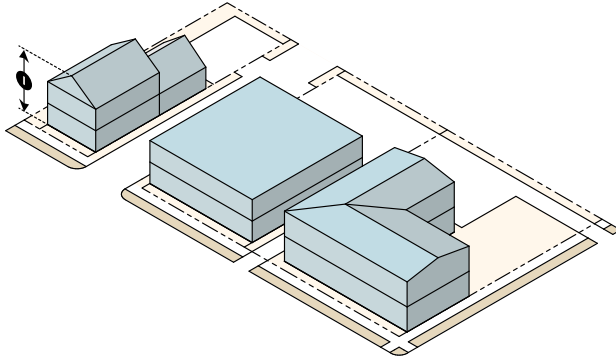

### Building Height

Minimum Building Height	None
<b>1</b> Maximum Building Height	35 ft & 2.5 Stories

## Activation:

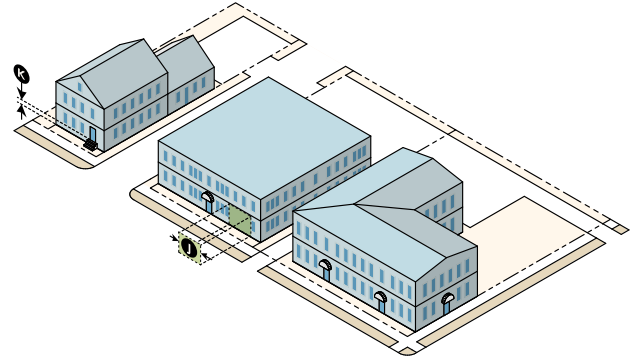

### Building Activation

<b>1</b> Maximum Blank Wall Area	20 ft
<b>2</b> Maximum Height of Building Entry Threshold Above Sidewalk	4 ft
Minimum Ground Floor Transparency	30%
Minimum Upper Floor Transparency	15%